



INSTALLATION GUIDE

**2022+ Subaru WRX Performance Top-Mount "Street"
Intercooler Kit | SKU: MMTMIC-WRX-22**

TABLE OF CONTENTS

- Pg 1** RESOURCES AND CONTACT INFORMATION
- Pg 2** EXPLODED VIEW & PARTS INCLUDED
- Pg 3** IMPORTANT SAFETY INFORMATION
REQUIRED TOOLS
INSTALLATION INSTRUCTIONS
- Pg 6** DISPOSAL INSTRUCTIONS
WARRANTY INFORMATION

RESOURCES & CONTACT

-  **CALL 1-877-GOMISHI**
CUSTOMER SERVICE HOURS: MON-FRI 8:30AM-5:00PM EST
-  **MISHIMOTO**
-  **GOMISHIMOTO**
-  **MISHIMOTO**
-  **WEBSITE**
WWW.MISHIMOTO.COM
-  **ENGINEERING BLOG**
WWW.MISHIMOTO.COM/ENGINEERING

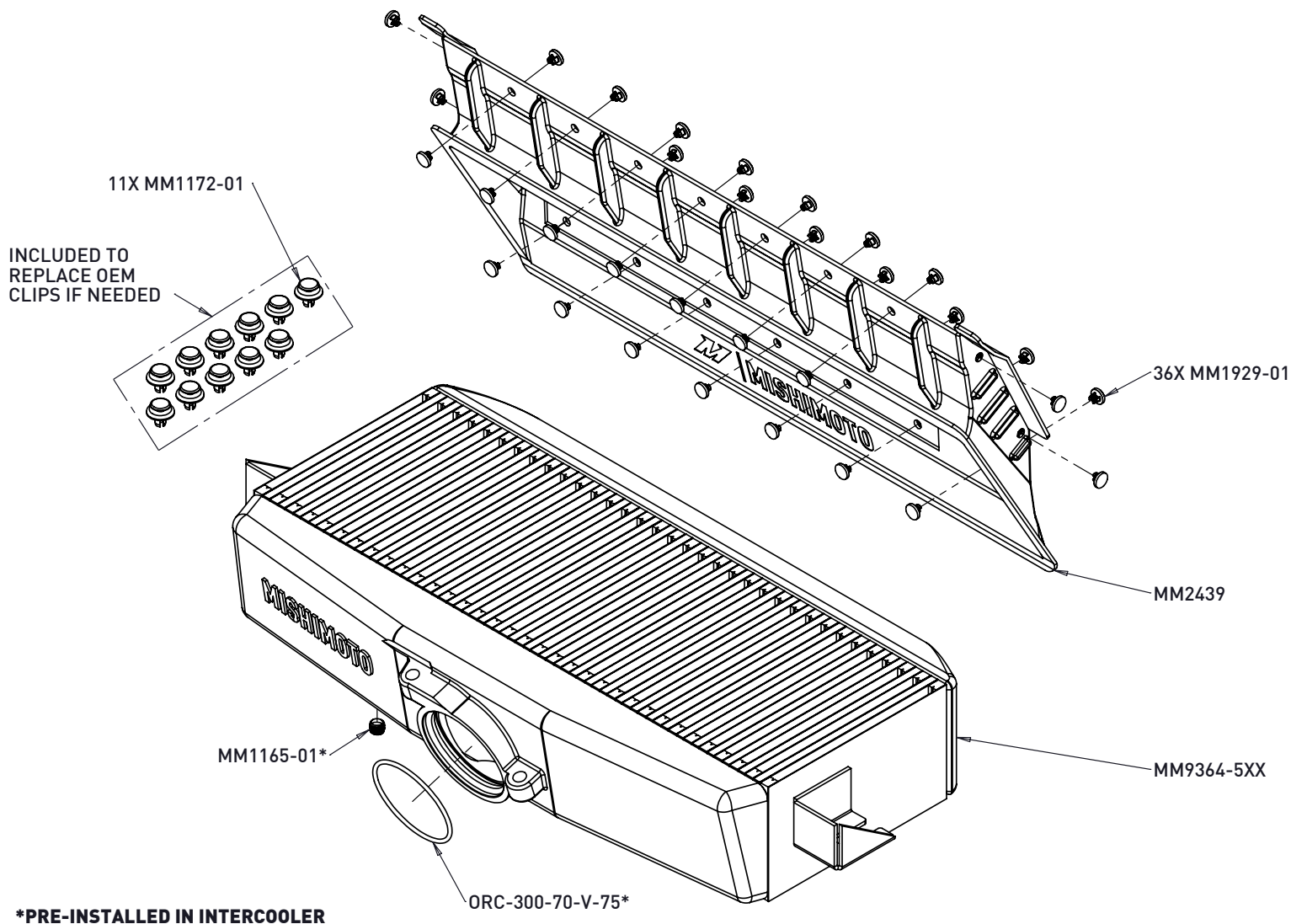

PARTS BREAKDOWN

PART NUMBER	DESCRIPTION	QTY
MM9364-5XX	INTERCOOLER	1
MM2439	SHROUD	1
MM1165-01	1/8" NPT PLUG	1
ORC-300-70-V-75	O-RING	1
MM1929-01	PLASTIC RIVETS	36
MM1172-01	PUSH-ON PANEL CLIP	11

IMPORTANT SAFETY INFORMATION

- › Mishimoto recommends you use safety glasses and protective gloves during the installation of our products
- › Raise vehicle only on jack stands or on a vehicle lift
- › Allow vehicle to cool completely prior to attempting installation
- › Do not run the engine or drive the vehicle while overheating; serious damage can occur
- › Please dispose of any liquids properly
- › Mishimoto is not responsible for any vehicle damage or personal injury due to installation errors, misuse, or removal of Mishimoto products
- › If you need any assistance while installing our products, reach out to our Customer Service Team at 1-877-GOMISHI

REQUIRED TOOLS

SOCKET DRIVER	SOCKET EXTENSION
8MM SOCKET	FLAT HEAD SCREWDRIVER
12MM SOCKET	

INSTALL TIME: 1 HOUR

INSTALL DIFFICULTY: 

DISCLAIMER

- Raise vehicle only on jack stands or on a vehicle lift.
- Allow vehicle to cool completely prior to attempting installation.
- Do not run the engine or drive the vehicle while overheating; serious damage can occur.
- Please dispose of any liquids properly.
- Mishimoto is not responsible for any vehicle damage or personal injury due to installation errors, misuse, or removal of Mishimoto products.
- Mishimoto suggests that a trained professional install all Mishimoto products.



BEFORE

AFTER

INSTALLATION INSTRUCTIONS

01. Using a 12mm socket, remove the four (4) bolts securing the intercooler to the vehicle.



02. Using a flathead screwdriver, release the spring clip that secures the two (2) sections of the charge pipe.



Continued on next page

03. Remove the two (2) rubber grommets from the brackets on the stock intercooler and install them into the brackets on the Mishimoto intercooler.

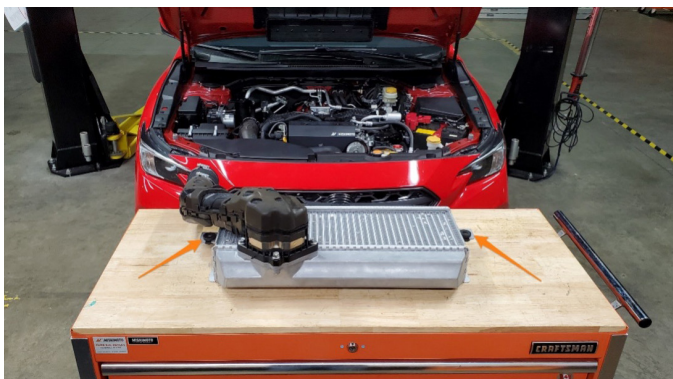

04. Using a 12mm socket, remove the three (3) bolts securing the charge pipe to the stock intercooler. Inspect the stock gasket in the charge pipe for damage. If the gasket is in good condition, it may be reused. If the gasket is damaged, it should be replaced with a new one (OEM part number 21896AA150).



05. Using a 12mm socket, install the stock charge pipe onto the Mishimoto intercooler with the three (3) bolts that were removed in Step 4. Tighten the bolts in the sequence shown below to 16Nm (11.8lb-ft).



06. Depress the spring clip that was disengaged in Step 2. Place the Mishimoto intercooler into position on the vehicle. Reconnect the charge pipe by pushing the section attached to the intercooler into the section attached to the engine until the spring clip clips into place. Then, using a 12mm socket, install the Mishimoto intercooler

Continued on next page

onto the vehicle with the four (4) bolts removed in step 1 and tighten to 16Nm [11.8lb-ft].



07. Using an 8mm socket and a flathead screwdriver (or pop clip removal tool), remove the four (4) bolts and eleven (11) pop clips that secure the intercooler shroud to the hood and remove the shroud from the vehicle. Replacement pop clips are included if any are broken or lost during removal.

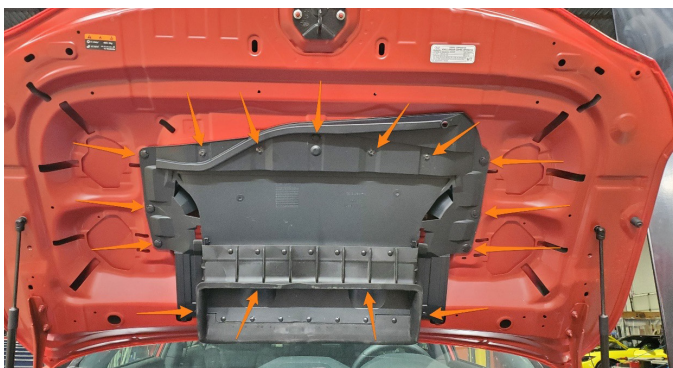

08. Remove the rubber part of the shroud from the plastic part by removing the 18 plastic rivets. The OEM rivets may need to be cut to be removed.

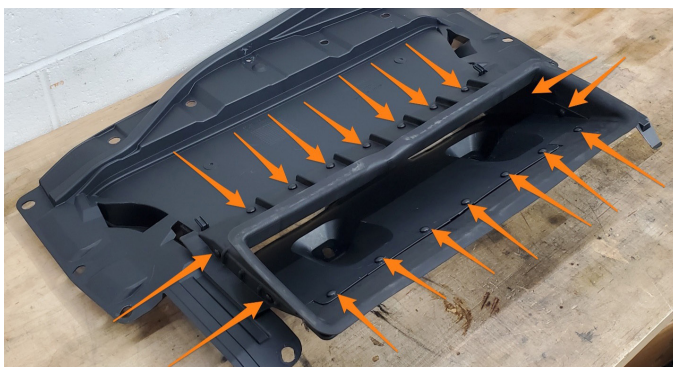

09. Install the included rubber Mishimoto intercooler shroud onto the plastic part of the stock shroud and secure it with the eighteen (18) supplied pairs of plastic rivets.



10. Using an 8mm socket and the four (4) bolts and eleven (11) pop clips that were removed in Step 7 (or the supplied replacement pop clips, if needed), install the shroud assembly back onto the hood.

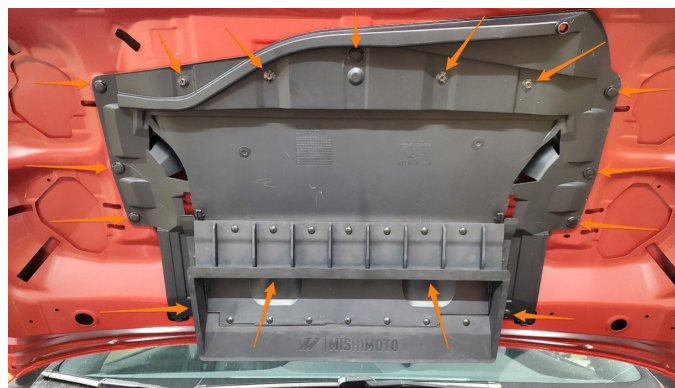

Congratulations. The installation is now complete.

DISPOSAL INSTRUCTIONS

- › Do not dispose of any product as unsorted municipal waste. Use separate collection facilities. Contact your local authority for information regarding the collection systems available.
- › Never improperly dispose of any coolant, oil, or other chemicals.

WARRANTY INFORMATION



- › All claims must be accompanied with a picture of the Mishimoto product showing the issue for which the claim is being submitted.
- › Mishimoto asks that the customer inspect their purchased item for any damage immediately upon arrival.
- › Any product deemed dead on arrival (DOA) must be claimed within 14 business days of delivery. Claims outside of this time frame will not be covered under the Mishimoto Lifetime Warranty.
- › This warranty does not include payment and/or reimbursement of the cost of labor in connection with the removal of any product returned pursuant to the warranty policy or in connection with the installation of any replacement items provided under the warranty policy.
- › Mishimoto has the right to refuse a claim at any time.

- › When Mishimoto accepts a claim, Mishimoto retains full discretion to choose if it will: (i) repair or replace purchaser's original Mishimoto product; (ii) replace purchaser's original Mishimoto product with the most current available model; or (iii) provide the purchaser with a gift card redeemable on [Mishimoto.com](https://www.mishimoto.com) in the amount of the original purchase price of the original Mishimoto product. The provision of a replacement of a Mishimoto product is subject to availability and Mishimoto retains the right to substitute any warranty claim item with a comparable item or credit at any time.
- › If Mishimoto determines that it will provide a replacement item in connection with a claim under this warranty policy, and such item is out of stock, Mishimoto will place the customer on backorder and ship the replacement product to the purchaser once it becomes available.
- › Mishimoto is not liable for incorrect shipments in connection with a claim if a claim form is completed incorrectly, or if a model number is not included in a claim.
- › If you have a vehicle equipped with an automatic transmission, please make sure to specify this within the text box on the claim form. Mishimoto is not responsible for incorrect replacement shipments if transmission type is not indicated.



WARNING
Cancer and
Reproductive Harm
www.P65Warnings.ca.gov

This product can expose you to chemicals which are known to the state of California to cause cancer. For more information visit: www.p65warnings.ca.gov