

MISHIMOTO

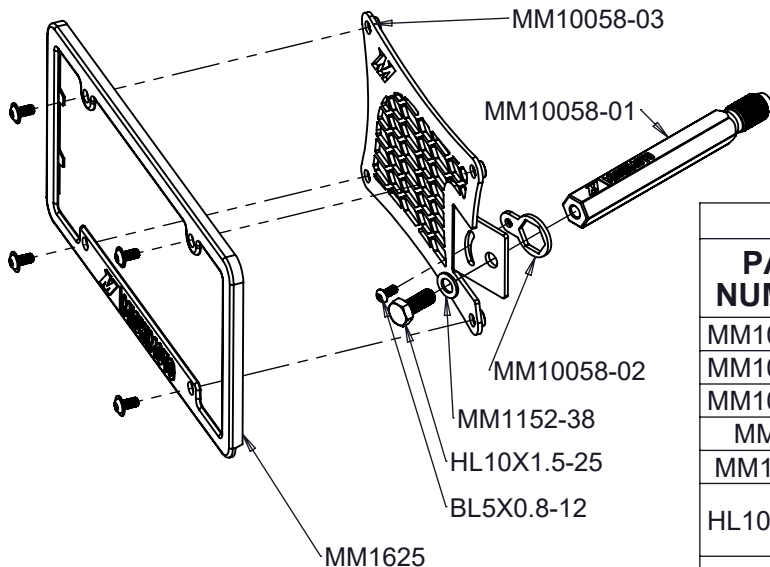

INSTALLATION STEPS:

1. PUSH THE TOP OF THE TOW HOOK COVER ON THE ARROW AND THE BOTTOM WILL POP OUT. REMOVE TOW HOOK COVER.
2. USING A 21MM WRENCH OR SOCKET, INSTALL MM10058-01 INTO THE TOW HOOK MOUNT. TORQUE TO 40 FT-LBS.
3. SLIDE MM10058-02 ONTO MM10058-01 AS SHOWN.
4. USING A 16MM WRENCH OR SOCKET, ATTACH MM10058-03 IN THE DESIRED ORIENTATION TO MM10058-01 WITH MM1152-38 & HL10X1.5-25. TORQUE TO 40 FT-LBS.
5. USING A 3MM ALLEN WRENCH, INSTALL BL5X0.8-12 THROUGH THE SLOT IN MM10058-03 INTO MM10058-02 AND TIGHTEN TO LOCK THE ROTATION OF MM10058-03
6. USING A 4MM ALLEN WRENCH, ATTACH YOUR LICENSE PLATE TO MM10058-03 WITH (4) BF6X1.0-12B

BILL OF MATERIALS

PART NUMBER	DESCRIPTION	QUANTITY
MM10058-01	SHAFT	1
MM10058-02	BRACKET 1	1
MM10058-03	BRACKET 2	1
MM1625	PLATE FRAME	1
MM1152-38	FLAT WASHER	1
HL10X1.5-25	M10 HEX HEAD LOCKING BOLT	1
BL5X0.8-12	M5 BUTTON HEAD LOCKING BOLT	1
BF6X1.0-12B	M6 BUTTON HEAD FLANGED BOLT	4

FOR QUESTIONS OR ASSISTANCE WITH YOUR MISHIMOTO PRODUCT,
CONTACT US AT 1.877.GOMISHI OR SUPPORT@MISHIMOTO.COM