

MISHIMOTO

INSTALLATION STEPS:

1. USING A TRIM REMOVAL TOOL, REMOVE THE TOW HOOK COVER ON THE FRONT BUMPER TO ACCESS THE FRONT TOW HOOK MOUNT.
2. USING A 21MM WRENCH OR SOCKET, INSTALL MM10100-02 INTO THE TOW HOOK MOUNT. **NOTE: THE THREADS ARE REVERSE THREADED, ROTATE TO THE LEFT TO TIGHTEN.**
3. SLIDE MM10100-03 ONTO MM10100-02.
4. USING A 16MM WRENCH OR SOCKET, ATTACH MM10100-01 TO MM10100-02 WITH MM1152-38 & HL10X1.5-25.
5. USING A 3MM ALLEN WRENCH, INSTALL BL5X0.8-12 THROUGH THE SLOT IN MM10100-01 INTO MM10100-03 AND TIGHTEN TO LOCK THE ROTATION OF MM10100-01.
6. USING A 4MM ALLEN WRENCH, ATTACH YOUR LICENSE PLATE TO MM10100-01 WITH (4) BF6X1.0-12B.

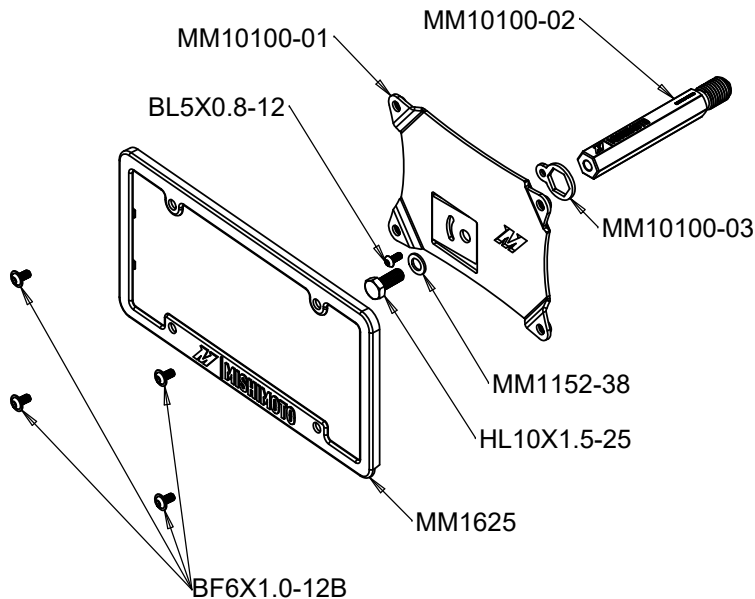

FOR QUESTIONS OR ASSISTANCE WITH YOUR MISHIMOTO PRODUCT,
CONTACT US AT 1.877.GOMISHI OR SUPPORT@MISHIMOTO.COM

BILL OF MATERIALS

| PART NUMBER | DESCRIPTION | QUANTITY |
|-------------|-----------------------------|----------|
| MM10100-01 | BRACKET 1 | 1 |
| MM10100-02 | ROD | 1 |
| MM10100-03 | BRACKET 2 | 1 |
| MM1152-38 | FLAT WASHER | 1 |
| MM1625 | PLATE FRAME | 1 |
| HL10X1.5-25 | M10 HEX HEAD LOCKING BOLT | 1 |
| BL5X0.8-12 | M5 BUTTON HEAD LOCKING BOLT | 1 |
| BF6X1.0-12B | M6 BUTTON HEAD FLANGED BOLT | 4 |