



INSTALLATION GUIDE

Performance Intake, Fits 2023+ Toyota GR Corolla
SKU: MMAI-GRC-23

TABLE OF CONTENTS

1. RESOURCES & CONTACT INFO
2. EXPLODED VIEW & PARTS BREAKDOWN
3. IMPORTANT SAFETY INFORMATION
INSTALL TIME & DIFFICULTY
REQUIRED TOOLS
7. DISPOSAL & WARRANTY INFORMATION

RESOURCES & CONTACT



CALL 1.877.466.4744

CUSTOMER SERVICE HOURS: MON-FRI 9:00AM-7:00PM EST



@MISHIMOTO



@GOMISHIMOTO



MISHIMOTO



@MISHIMOTO



ENGINEERING BLOG

WWW.MISHIMOTO.COM/ENGINEERING

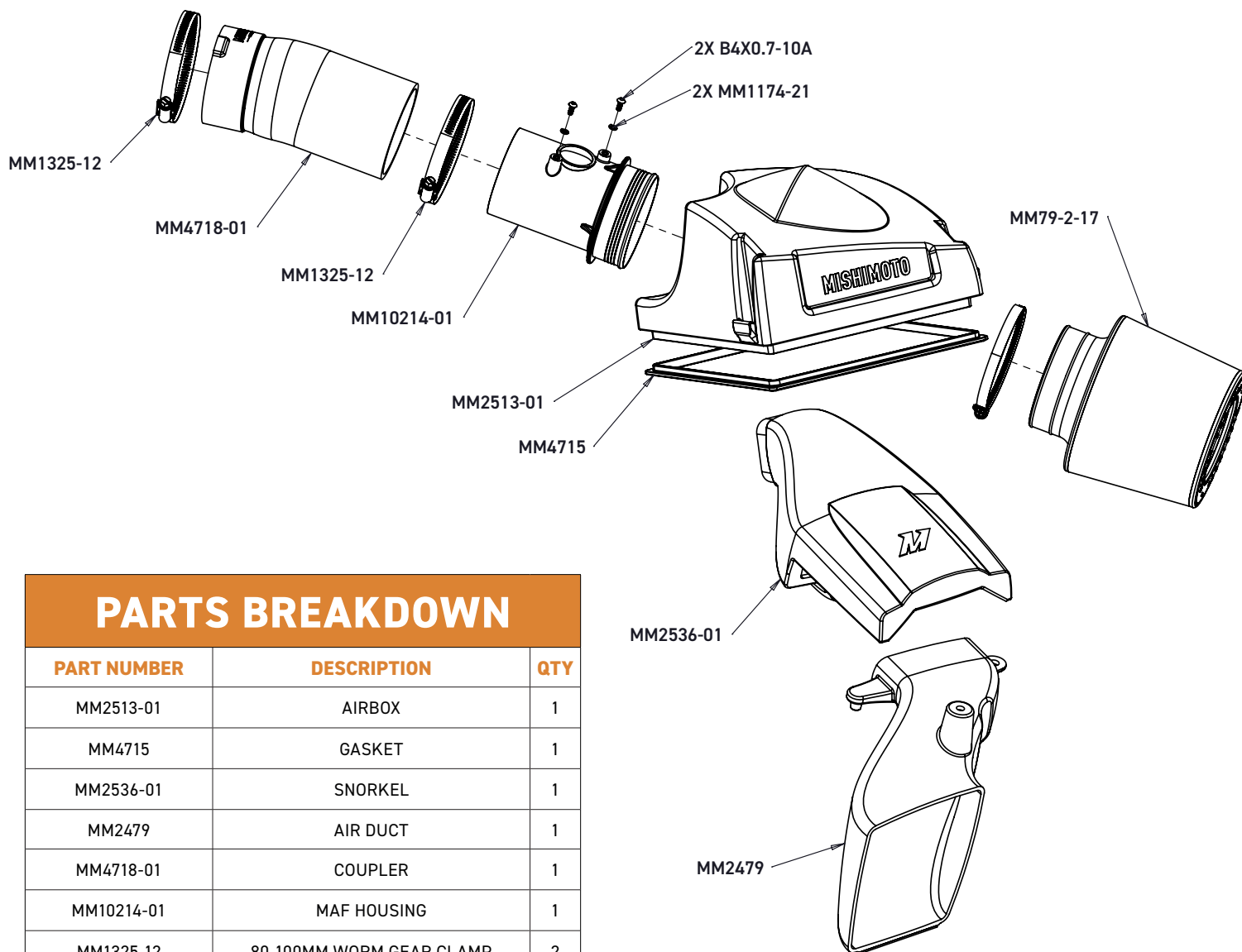

PARTS BREAKDOWN

PART NUMBER	DESCRIPTION	QTY
MM2513-01	AIRBOX	1
MM4715	GASKET	1
MM2536-01	SNORKEL	1
MM2479	AIR DUCT	1
MM4718-01	COUPLER	1
MM10214-01	MAF HOUSING	1
MM1325-12	80-100MM WORM GEAR CLAMP	2
MM79-2-17	AIR FILTER WITH CLAMP	1
MM1174-21	LOCK WASHER	2
B4X0.7-10A	M4X10MM BUTTON HEAD BOLT	2

Continued on next page

IMPORTANT SAFETY INFORMATION

- › Mishimoto recommends you use safety glasses and protective gloves during the installation of our products
- › Raise vehicle only on jack stands or on a vehicle lift
- › Allow vehicle to cool completely prior to attempting installation
- › Do not run the engine or drive the vehicle while overheating; serious damage can occur
- › Please dispose of any liquids properly
- › Mishimoto is not responsible for any vehicle damage or personal injury due to installation errors, misuse, or removal of Mishimoto products
- › If you need any assistance while installing our products, reach out to our Customer Service Team at 1-877-GOMISHI

REQUIRED TOOLS

2.5MM HEX KEY	POP CLIP TOOL
8MM SOCKET	HACK SAW
10MM SOCKET	CENTER PUNCH
RATCHET WRENCH	1/4INCH (6.35MM) DRILL BIT
PHILLIPS SCREWDRIVER	ELECTRIC DRILL

INSTALL TIME: 1 HOUR

INSTALL DIFFICULTY:     

INSTALLATION INSTRUCTIONS

1. Loosen the hose clamp (10mm socket).



2. Pull the 2 hoses out of the clips.



3. Release the two airbox clips and unplug the MAF sensor electrical connector. Remove the airbox lid and hose from the vehicle.



4. Remove the stock air filter.

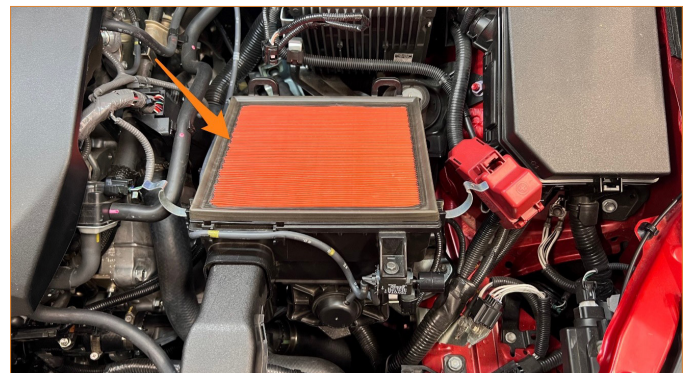

Continued on next page

5. Remove the 7x pop clips then remove the plastic shroud.

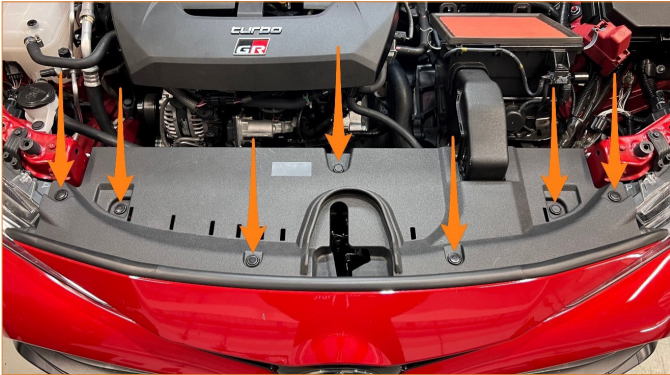

6. Remove the 4x pop clips then remove the two plastic intake ducts.

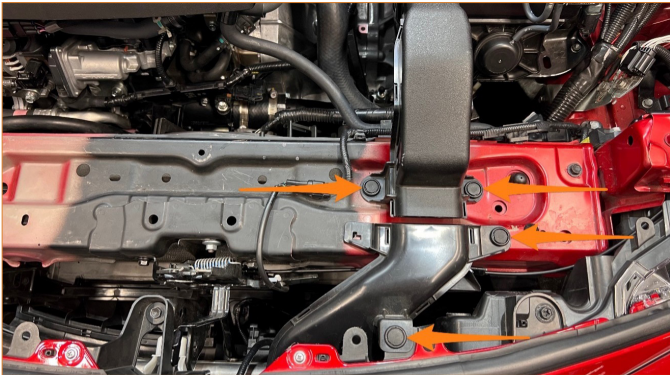

7. Install the Mishimoto air duct as shown and fasten using the stock pop clips.

Note: The plastic shroud removed in step 5 needs to be modified to fit the larger inlet on the Mishimoto snorkel.



8. On the backside of the shroud, the cut line is marked in silver. The cut will be made on the inside of the reinforcing ribs, so they are retained for

strength. The locations for the holes are also shown. The hole size to be drilled is 6.35mm or 1/4inch.

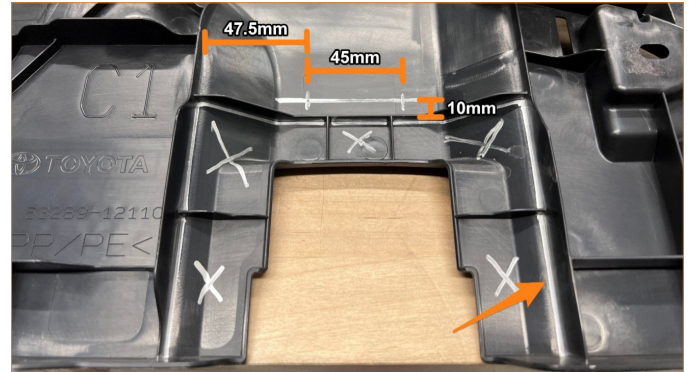

9. Shown below is what the shroud should look like after modification.

Note: The holes shown are slotted but should be round.



10. Install the Mishimoto snorkel onto the modified shroud and fasten with the provided tree clips.

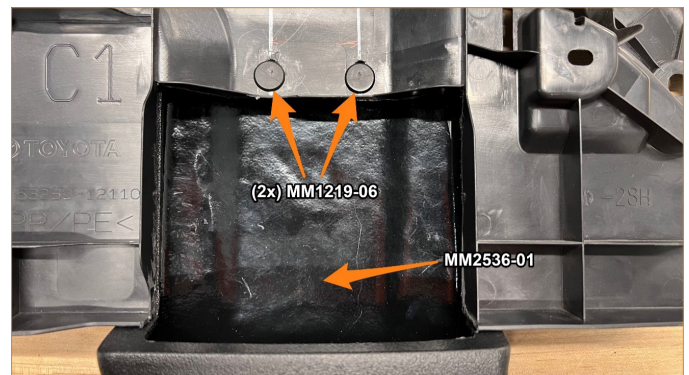

Continued on next page

11. Install the shroud and snorkel assembly into the vehicle as shown.



12. Ensure the top part of the snorkel is fully inserted into the inlet on the stock airbox and the bottom part of the snorkel is lined up with the lower inlet on the stock airbox. Secure the shroud with the stock pop clips.

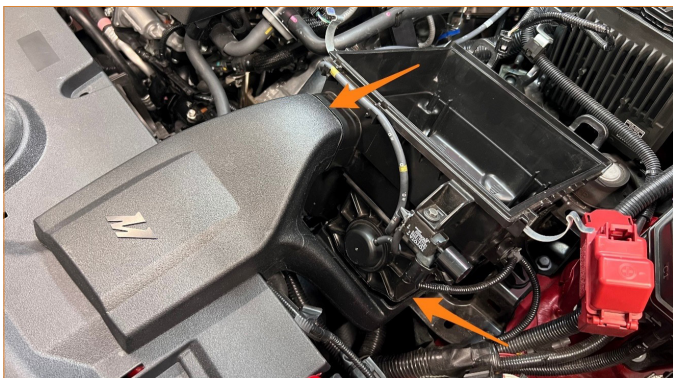

13. Remove the 2x screws (Phillips head) then remove the MAF sensor from the stock housing.



14. Install the MAF sensor into the Mishimoto MAF housing using the provided M4 hardware.



15. Insert the MAF housing into the Mishimoto airbox (flanged side first) then, install the air filter onto the MAF housing. Tighten the air filter hose clamp (8mm socket).



16. Install the Mishimoto coupler onto the stock turbo inlet pipe being sure to line up the notch.

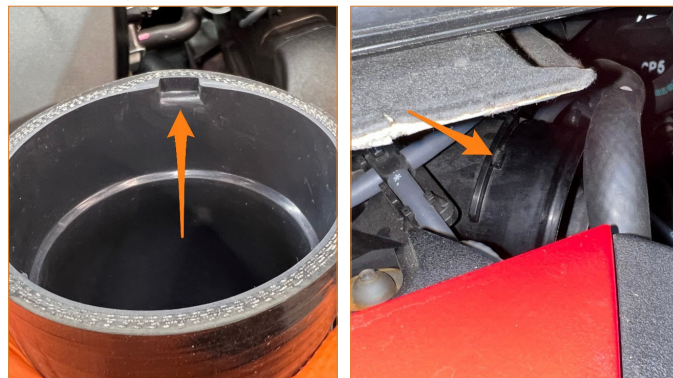

Continued on next page

17. Install the airbox assembly in the vehicle as shown and secure with the two stock airbox clips. Secure the coupler with the two provided worm gear clamps (7mm socket). Plug the MAF sensor back in.

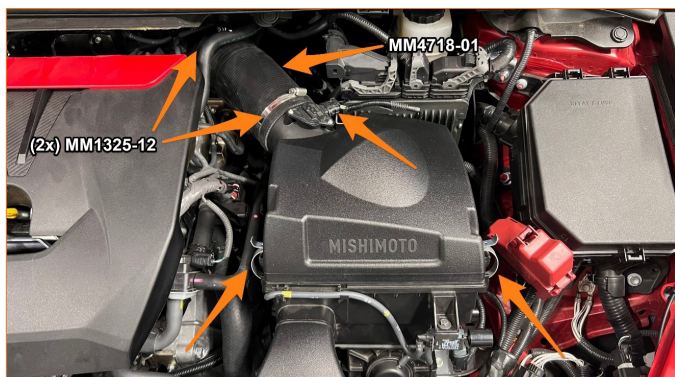

This concludes the installation.

DISPOSAL INSTRUCTIONS

- › Do not dispose of any product as unsorted municipal waste. Use separate collection facilities. Contact your local authority for information regarding the collection systems available.
- › Never improperly dispose of any coolant, oil, or other chemicals

WARRANTY INFORMATION



- › All claims must be accompanied with a picture of the Mishimoto product showing the issue for which the claim is being submitted.
- › Mishimoto asks that the customer inspect their purchased item for any damage immediately upon arrival.
- › Any product deemed dead on arrival (DOA) must be claimed within 14 business days of delivery. Claims outside of this time frame will not be covered under the Mishimoto Lifetime Warranty.
- › This warranty does not include payment and/or reimbursement of the cost of labor in connection with the removal of any product returned pursuant to the warranty policy or in connection with the installation of any replacement items provided under the warranty policy.
- › Mishimoto has the right to refuse a claim at any time.

- › When Mishimoto accepts a claim, Mishimoto retains full discretion to choose if it will: (i) repair or replace purchaser's original Mishimoto product; (ii) replace purchaser's original Mishimoto product with the most current available model; or (iii) provide the purchaser with a gift card redeemable on **Mishimoto.com** in the amount of the original purchase price of the original Mishimoto product. The provision of a replacement of a Mishimoto product is subject to availability and Mishimoto retains the right to substitute any warranty claim item with a comparable item or credit at any time.
- › If Mishimoto determines that it will provide a replacement item in connection with a claim under this warranty policy, and such item is out of stock, Mishimoto will place the customer on backorder and ship the replacement product to the purchaser once it becomes available.
- › Mishimoto is not liable for incorrect shipments in connection with a claim if a claim form is completed incorrectly, or if a model number is not included in a claim.
- › If you have a vehicle equipped with an automatic transmission, please make sure to specify this within the text box on the claim form. Mishimoto is not responsible for incorrect replacement shipments if transmission type is not indicated.



WARNING
Cancer and
Reproductive Harm
www.P65Warnings.ca.gov

- › This product can expose you to chemicals which are known to the state of California to cause cancer. For more information visit: www.p65warnings.ca.gov