



# INSTALLATION GUIDE

Performance Intake, fits 2022+ Honda Civic 1.5T  
SKU: MMAI-CIV-22

## TABLE OF CONTENTS

1. RESOURCES & CONTACT INFO
2. EXPLODED VIEW
3. IMPORTANT SAFETY INFORMATION  
INSTALL TIME & DIFFICULTY  
REQUIRED TOOLS  
INSTALLATION INSTRUCTIONS
5. DISPOSAL & WARRANTY INFORMATION

## RESOURCES & CONTACT



**CALL 1.877.466.4744**

CUSTOMER SERVICE HOURS: MON-FRI 9:00AM-7:00PM EST



**@MISHIMOTO**



**@GOMISHIMOTO**



**MISHIMOTO**



**@MISHIMOTO**



**ENGINEERING BLOG**

[WWW.MISHIMOTO.COM/ENGINEERING](http://WWW.MISHIMOTO.COM/ENGINEERING)

### PARTS BREAKDOWN

PART NUMBER	DESCRIPTION	QTY
MM2517	AIRBOX	1
MM4709-01	COUPLER	1
MM4711	GROMMET	1
MM10206-01	MAF HOUSING	1
MM79-2-06	AIR FILTER	1
MM1174-13	M4 LOCK WASHER	2
B4X0.7-10A	M4X10MM BUTTON HEAD BOLT	2
MM1325-10	60-80MM WORM GEAR CLAMP	2
	AIR FILTER CLAMP	1

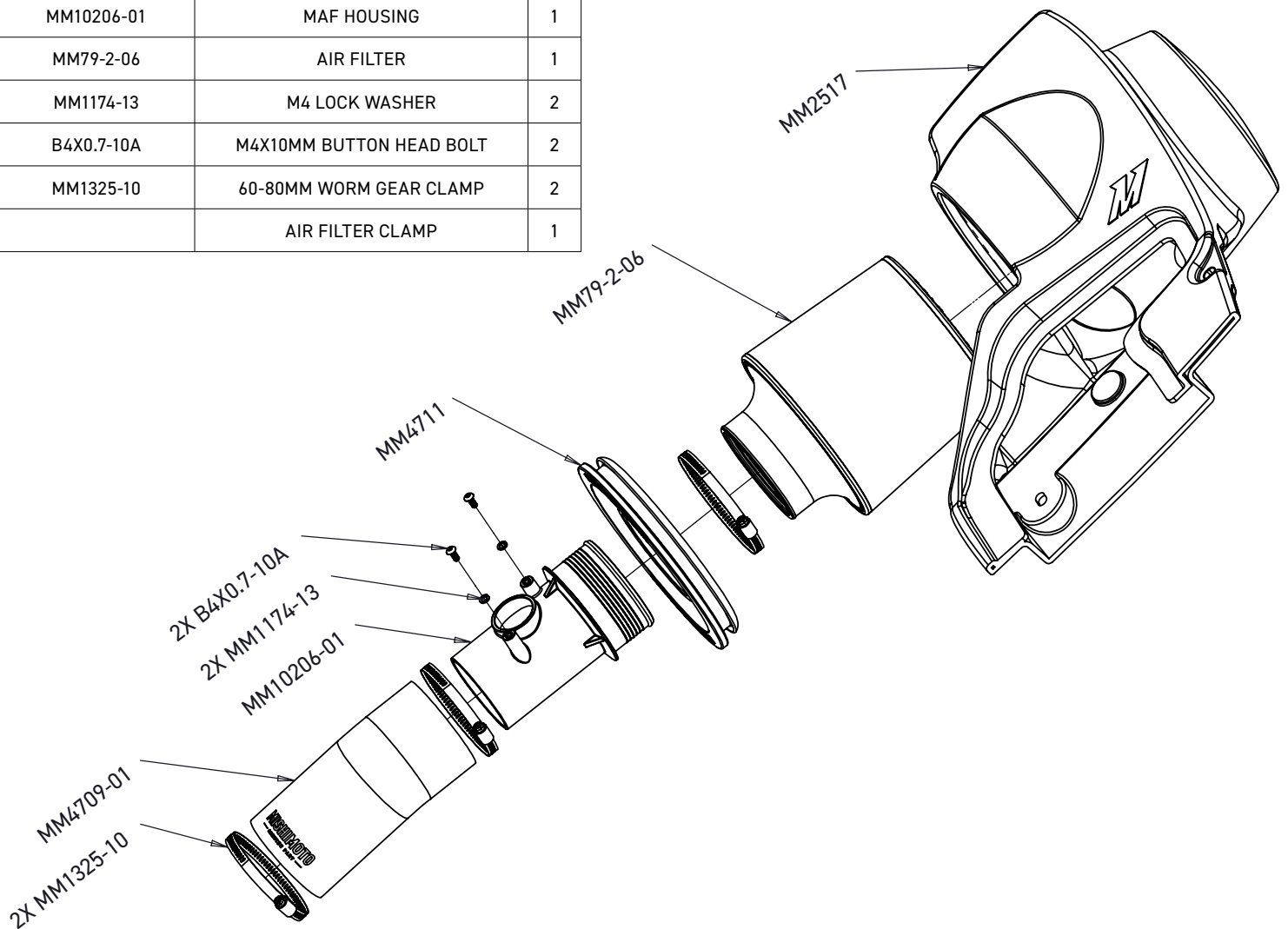

Continued on next page

### IMPORTANT SAFETY INFORMATION

- › Mishimoto recommends you use safety glasses and protective gloves during the installation of our products
- › Raise vehicle only on jack stands or on a vehicle lift
- › Allow vehicle to cool completely prior to attempting installation
- › Do not run the engine or drive the vehicle while overheating; serious damage can occur
- › Please dispose of any liquids properly
- › Mishimoto is not responsible for any vehicle damage or personal injury due to installation errors, misuse, or removal of Mishimoto products
- › If you need any assistance while installing our products, reach out to our Customer Service Team at 1-877-GOMISHI

### REQUIRED TOOLS

2.5MM HEX KEY	10MM SOCKET
5.5MM SOCKET	RATCHET WRENCH
7MM SOCKET	PHILLIPS SCREWDRIVER
8MM SOCKET	POP CLIP TOOL

INSTALL TIME: **30 MINS**

INSTALL DIFFICULTY:     

\*Note: To avoid potential injury, wait for the vehicle to completely cool off before working in the engine bay.

### INSTALLATION INSTRUCTIONS

1. Loosen the hose clamp (5.5mm socket). Release the airbox clip.

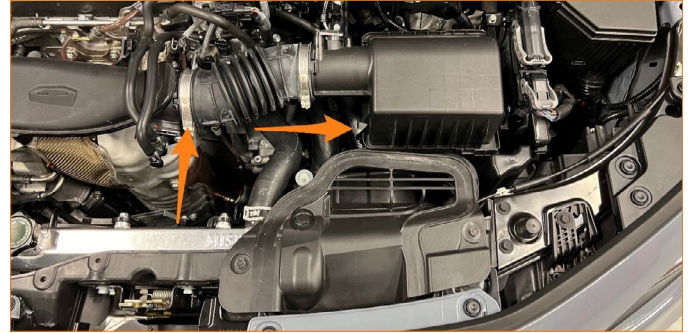

2. Unplug the electrical connector for the MAF sensor. Release the other airbox clip. Pull the loose end of the hose off the intake pipe then, remove the airbox lid and hose from the vehicle.

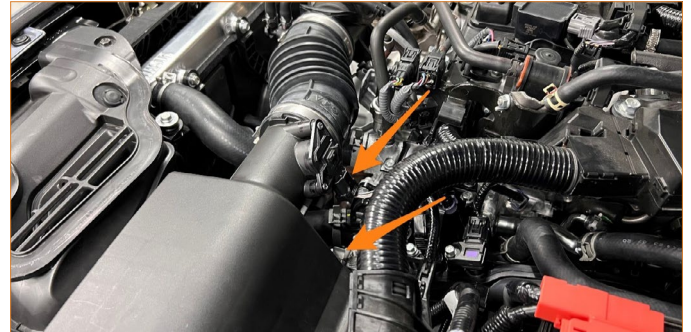

3. Remove the 4x bolts (10mm socket) and pop clip then, remove the lower half of the airbox from the vehicle.

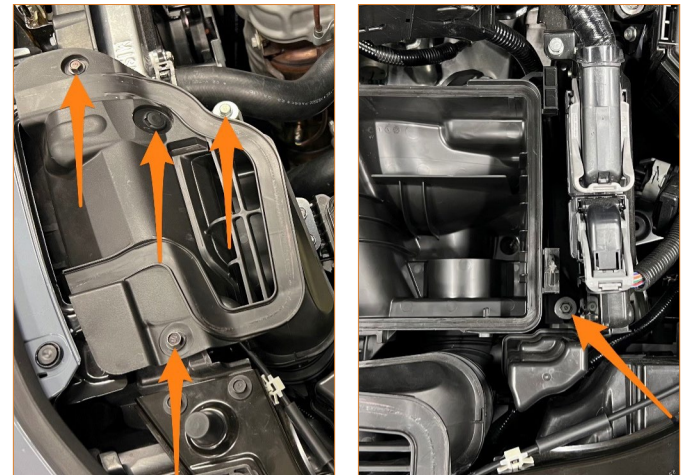

Continued on next page

4. Remove the 2x bolts (10mm socket) then, remove the bracket from the vehicle.

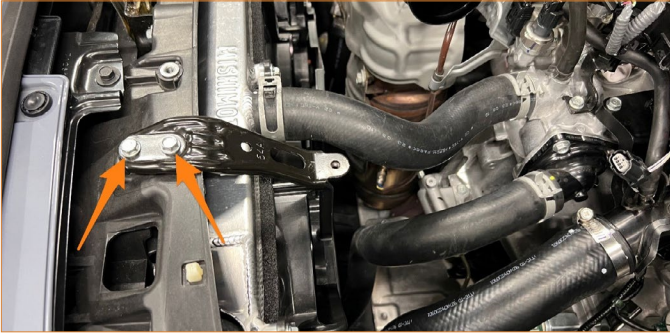

5. Remove the rubber grommet from the bottom half of the stock airbox and install it into the Mishimoto airbox.

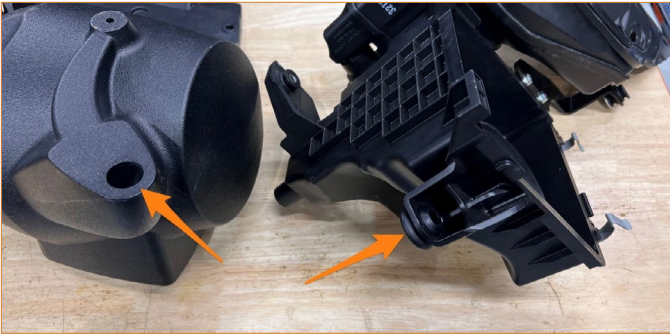

6. Remove the 2 screws (Phillips screwdriver) fastening the MAF sensor to the stock airbox lid then remove the MAF sensor from the housing.



7. Install the MAF sensor into the Mishimoto MAF housing as shown using the supplied M4 hardware and tighten the screws (2.5mm hex key).



8. Install the grommet onto the MAF housing as shown, followed by the filter. Ensure they are pushed all the way up against the flange on the MAF housing then, tighten the hose clamp on the filter (8mm socket).



9. Install the Mishimoto airbox into the vehicle as shown and fasten using the 2x bolts (10mm) removed in step 4.

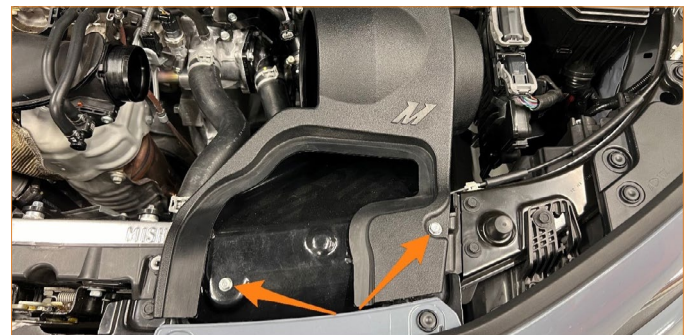

Continued on next page

10. Ensure the rubber grommet is pushed onto the lower mounting peg.

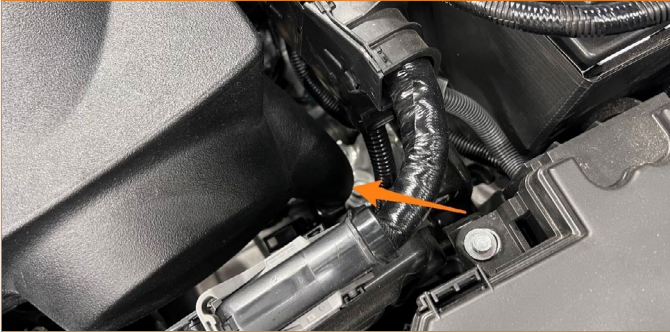

11. Install the MAF housing, filter, and grommet assembly into the airbox as shown, making sure the airbox is seated in the groove on the grommet all the way around the perimeter.

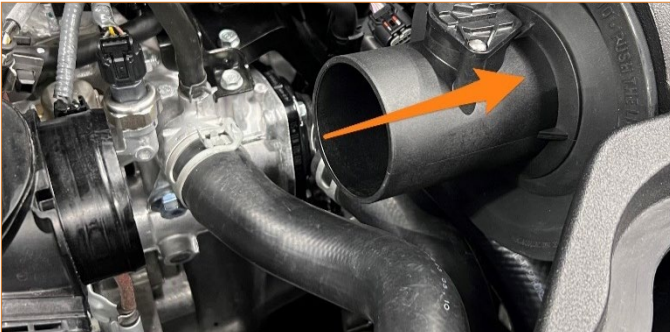

12. Remove the 90-degree outer housing from the MAF sensor plug.

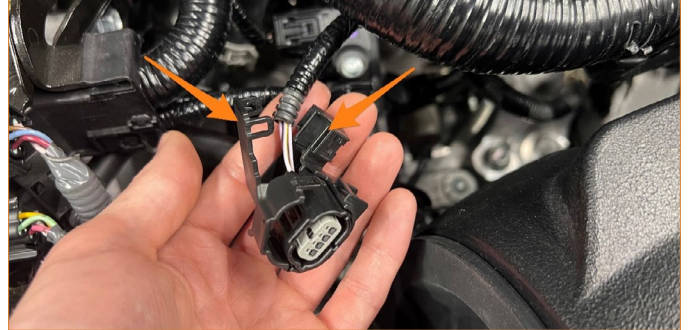

13. Plug the MAF sensor connector back in then, install the coupler as shown and fasten using the 2x supplied worm gear clamps (7mm socket).

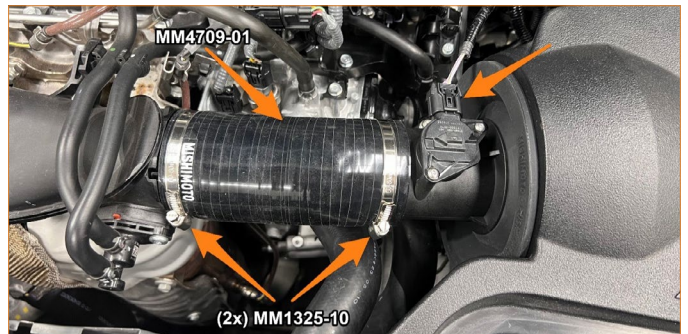

This concludes the installation.

Continued on next page

## DISPOSAL INSTRUCTIONS

- › Do not dispose of any product as unsorted municipal waste. Use separate collection facilities. Contact your local authority for information regarding the collection systems available.
- › Never improperly dispose of any coolant, oil, or other chemicals

## WARRANTY INFORMATION



- › All claims must be accompanied with a picture of the Mishimoto product showing the issue for which the claim is being submitted.
- › Mishimoto asks that the customer inspect their purchased item for any damage immediately upon arrival.
- › Any product deemed dead on arrival (DOA) must be claimed within 14 business days of delivery. Claims outside of this time frame will not be covered under the Mishimoto Lifetime Warranty.
- › This warranty does not include payment and/or reimbursement of the cost of labor in connection with the removal of any product returned pursuant to the warranty policy or in connection with the installation of any replacement items provided under the warranty policy.
- › Mishimoto has the right to refuse a claim at any time.

- › When Mishimoto accepts a claim, Mishimoto retains full discretion to choose if it will: (i) repair or replace purchaser's original Mishimoto product; (ii) replace purchaser's original Mishimoto product with the most current available model; or (iii) provide the purchaser with a gift card redeemable on **Mishimoto.com** in the amount of the original purchase price of the original Mishimoto product. The provision of a replacement of a Mishimoto product is subject to availability and Mishimoto retains the right to substitute any warranty claim item with a comparable item or credit at any time.
- › If Mishimoto determines that it will provide a replacement item in connection with a claim under this warranty policy, and such item is out of stock, Mishimoto will place the customer on backorder and ship the replacement product to the purchaser once it becomes available.
- › Mishimoto is not liable for incorrect shipments in connection with a claim if a claim form is completed incorrectly, or if a model number is not included in a claim.
- › If you have a vehicle equipped with an automatic transmission, please make sure to specify this within the text box on the claim form. Mishimoto is not responsible for incorrect replacement shipments if transmission type is not indicated.



**WARNING**  
Cancer and  
Reproductive Harm  
[www.P65Warnings.ca.gov](http://www.P65Warnings.ca.gov)

- › This product can expose you to chemicals which are known to the state of California to cause cancer. For more information visit: [www.p65warnings.ca.gov](http://www.p65warnings.ca.gov)