



INSTALLATION GUIDE

Borne Off-Road Universal Lighting
SKU: BNLT-LB, BNLT-LP, BNLT-RL, BNLT-RD7

TABLE OF CONTENTS

1. RESOURCES & CONTACT INFO
2. IMPORTANT SAFETY INFORMATION
LIGHT POD INSTALLATION
3. LIGHT BAR INSTALLATION
4. ROUND LIGHT INSTALLATION
5. ROCK LIGHT INSTALLATION
6. SWITCH WIRING DIAGRAMS

RESOURCES & CONTACT



CALL 1.877.466.4744

CUSTOMER SERVICE HOURS: MON-FRI 8:30AM-5:00PM EST



@BORNEOFFROAD



@BORNEOFF-ROAD



BORNEOFFROAD



@BORNEOFFROAD



ENGINEERING BLOG

WWW.BORNE.COM/ENGINEERING

IMPORTANT SAFETY INFORMATION

- ▶ Please read through all of these instructions and tips before proceeding with installation. We aim to provide a simple installation process for all applications. However, a professional installation is always recommended.
- ▶ **IMPORTANT** – Always disconnect any power sources connected to your vehicle before servicing fuses or electrical systems.

NOTE

1. Borne Off-Road lights are designed to operate from 9V-16V only. Using this product on a 24V or higher system will cause permanent damage to electrical components.
2. These lights are intended for off-road use only.

HOW TO SWITCH LIGHT OUTPUT

1. Turn the light ON for two seconds.
2. Quickly turn the light OFF/ON two times.
3. To change the light output again, turn OFF for two seconds, then repeat steps 1 and 2.

LIGHT PODS	
DESCRIPTION	QUANTITY
M6 Lock Washers	4
M6 Button Head Bolts	4
Nylon Fastener Covers	4
M8 Hex Head Bolts	2
M8 Nylon Lock Nuts	2
Universal Mounting Brackets	2
Universal Wiring Harness	1

MOUNTING INSTALLATION INSTRUCTIONS

1. Insert mounting brackets onto light as shown.
2. Secure hardware to a snug position and mount your light in desired location.

WIRING HARNESS INSTALLATION INSTRUCTIONS

1. Always disconnect the negative battery terminal when working with any electrical circuits.
2. When routing wires through any metal or abrasive surfaces, ensure the surface is free of any sharp edges to prevent wire damage and/or electrical shorts.
3. Route main power and ground leads from the harness to the battery terminals and attach the RED lead to battery +12V and BLACK lead directly to battery ground.
4. Reconnect the negative battery terminal and test switches to verify functionality.
5. Your installation is now complete!

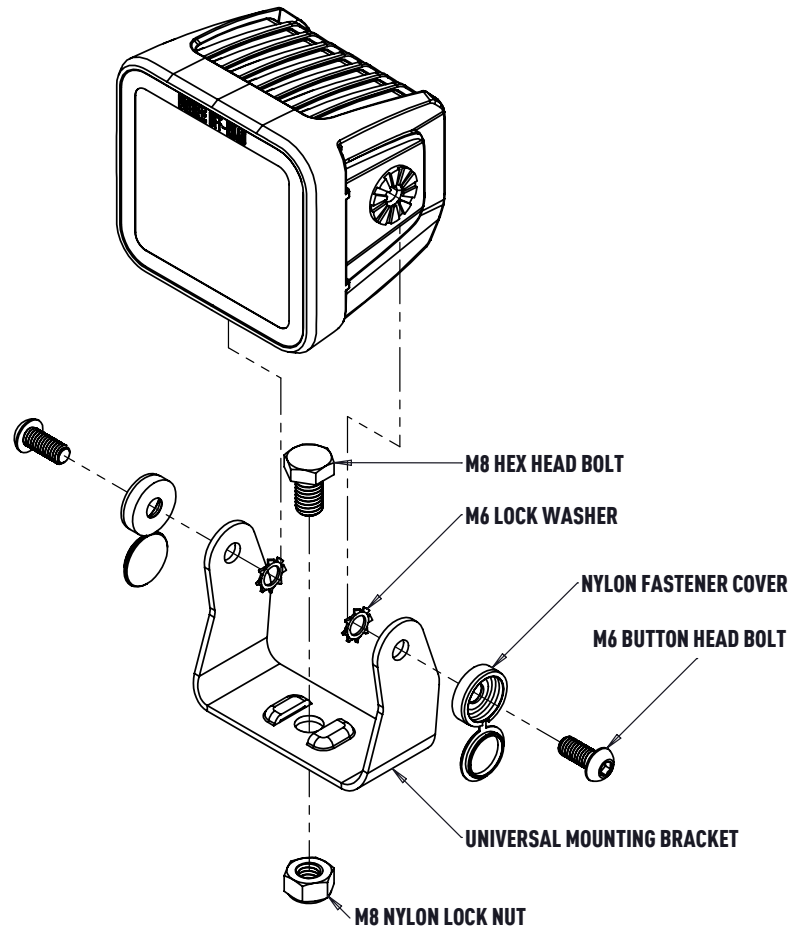

Continued on next page

LIGHT BARS	
DESCRIPTION	QUANTITY
M8 Lock Washers	2
M8 Button Head Bolts	2
Nylon Fastener Covers	2
M8 Hex Head Bolts	2
M8 Nylon Lock Nuts	2
Universal Mounting Brackets	2
Universal Harness Pigtail	1
Black Light Cover	1

MOUNTING INSTALLATION INSTRUCTIONS

1. Insert mounting brackets onto light as shown.
2. Secure hardware to a snug position and mount your light in desired location.

WIRING HARNESS INSTALLATION INSTRUCTIONS

1. Always disconnect the negative battery terminal when working with any electrical circuits.
2. When routing wires through any metal or abrasive surfaces, ensure the surface is free of any sharp edges to prevent wire damage and/or electrical shorts.
3. Route main power and ground leads from the harness to the battery terminals and attach the RED lead to battery +12V and BLACK lead directly to battery ground.
4. Reconnect the negative battery terminal and test switches to verify functionality.
5. Your installation is now complete!

WIRING HARNESS PIGTAIL

1. Black Wire: Ground.
2. Red Wire: Main LED Lighting
3. White Wire: White DRL
4. Yellow Wire: Amber DRL

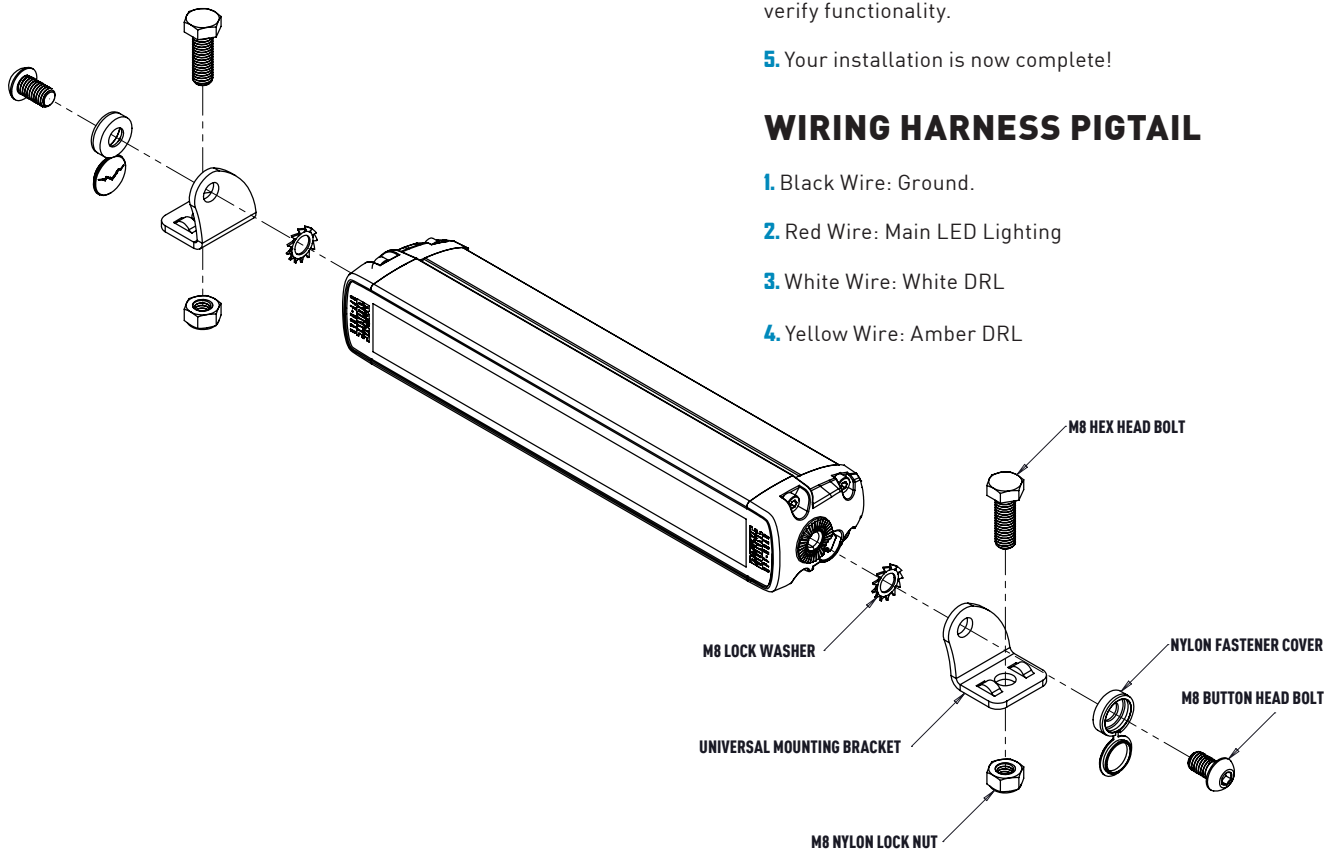

Continued on next page

ROUND LIGHTS	
DESCRIPTION	QUANTITY
M6 Lock Washers	8
M6 Button Head Bolts	8
M10 Bolts	2
M10 Nylon Lock Nuts	2
M6 Flat Washers	8
Universal Mounting Brackets	2
Universal Wiring Harness	1
Black Light Covers	2

Round Lights Come Pre-Assembled

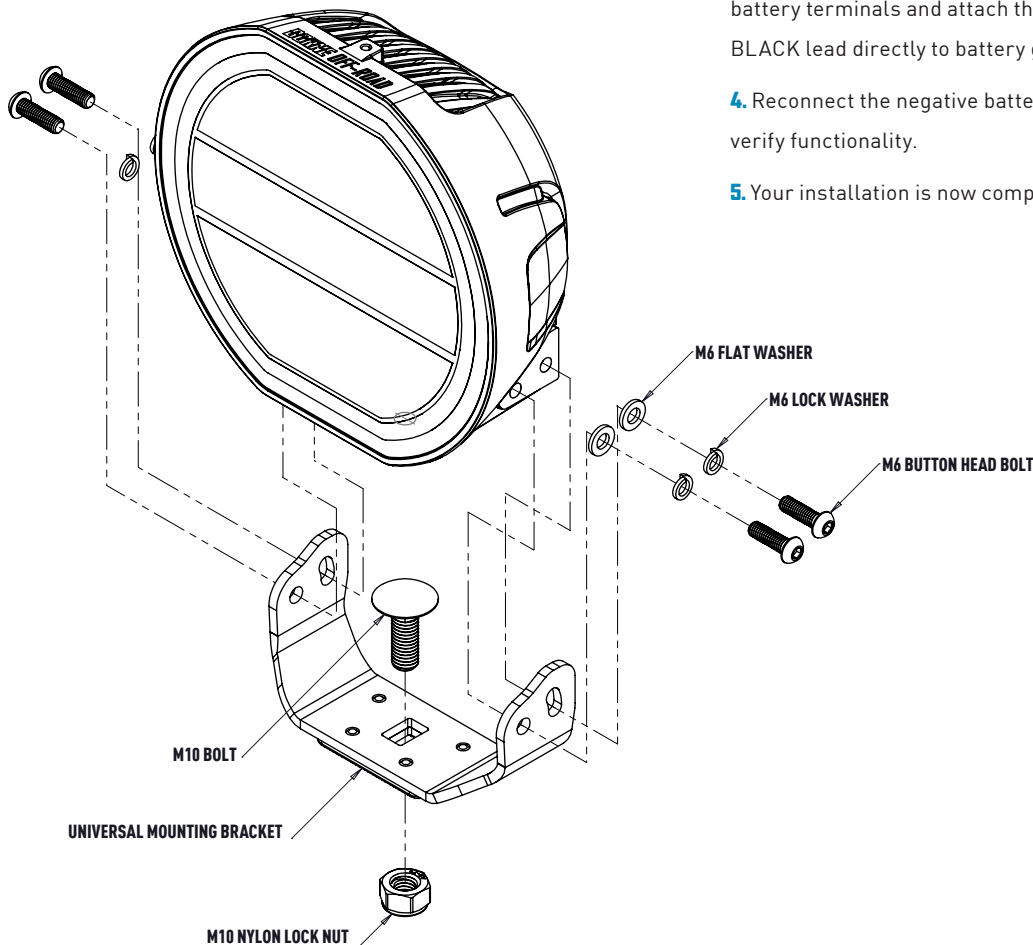

MOUNTING INSTALLATION INSTRUCTIONS

1. Insert mounting brackets onto light as shown.
2. Secure hardware to a snug position and mount your light in desired location.

WIRING HARNESS INSTALLATION INSTRUCTIONS

1. Always disconnect the negative battery terminal when working with any electrical circuits.
2. When routing wires through any metal or abrasive surfaces, ensure the surface is free of any sharp edges to prevent wire damage and/or electrical shorts.
3. Route main power and ground leads from the harness to the battery terminals and attach the RED lead to battery +12V and BLACK lead directly to battery ground.
4. Reconnect the negative battery terminal and test switches to verify functionality.
5. Your installation is now complete!

Continued on next page

ROCK LIGHTS	
DESCRIPTION	QUANTITY
Flat Mounting Pads	4
Curved Mounting Pads	4
Short Jumper Harnesses	2
Long Jumper Harnesses	2
Universal Wiring Harness	1

MOUNTING INSTALLATION INSTRUCTIONS

1. Secure hardware to a snug position and mount your light in desired location.

WIRING HARNESS INSTALLATION INSTRUCTIONS

1. Always disconnect the negative battery terminal when working with any electrical circuits.

2. When routing wires through any metal or abrasive surfaces, ensure the surface is free of any sharp edges to prevent wire damage and/or electrical shorts.

3. Route main power and ground leads from the harness to the battery terminals and attach the RED lead to battery +12V and BLACK lead directly to battery ground.

4. Reconnect the negative battery terminal and test switches to verify functionality.

5. Your installation is now complete!

SWITCH WIRING DIAGRAMS

2 POSITION SWITCH: ON/OFF

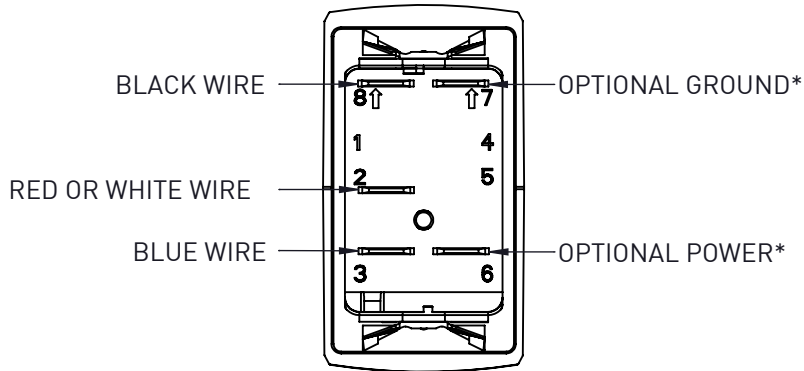

*TO ILLUMINATE BOTTOM HALF OF SWITCH. WIRING NOT INCLUDED.

3 POSITION SWITCH: ON/OFF/ON

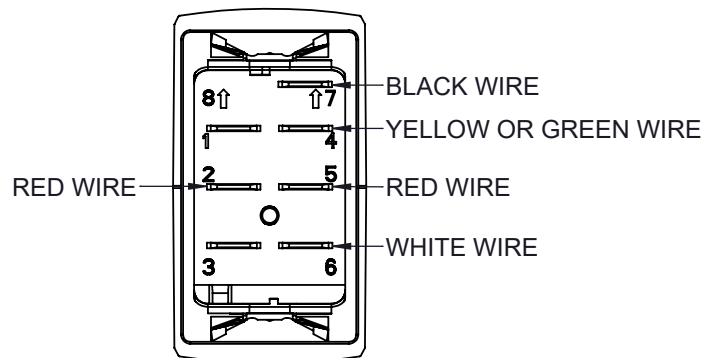

Continued on next page