

# 2011-2014 FORD F-150 3.5L ECOBOOST BAFFLED OIL CATCH CAN KIT PARTS LIST & INSTALLATION GUIDE



## PARTS INCLUDED

- 1PC** 12 oz Anodized 6061 Aluminum Catch Can
- 1PC** 7.5 oz Anodized 6061 Aluminum Catch Can
- 2PC** Application-Specific Mounting Bracket
- 4PC** Direct-Fit Hoses w/ Pre-Installed Quick-Disconnect Fittings and Check Valve
- 4PC** Worm Gear Clamps
- 4PC** CNC-Machined Aluminum Barbed Fittings
- 2PC** Bronze Filters
- 2PC** Air Diverters
- 2PC** Internal Baffle & Rod
- 2PC** 3/8" NPT Plug
- 2PC** Large O-Ring
- Mounting Hardware

## TOOLS NEEDED

- 2.5mm Allen Key
- 3mm Allen Key
- Pop Clip Pliers
- 5mm Socket
- 7mm Socket
- 8mm Socket
- 10mm Socket
- 13mm Socket
- 3/8" Drive Ratchet

**INSTALL TIME** 2 Hours

**INSTALL DIFFICULTY** 🛠️🔧🔧🔧🔧

## DISCLAIMER

- Allow vehicle to cool completely prior to attempting installation.
- Mishimoto is not responsible for any vehicle damage or personal injury due to installation errors, misuse, or removal of Mishimoto products.
- Mishimoto suggests that a trained professional install all Mishimoto products.

## INSTALL PROCEDURE

1. Remove the oil cap and engine cover. Lift the front of the cover up and pull it toward you to free the back end.

2. The hose orientation for installation should look like the image below. A copy of the graphic is included in your kit for reference.

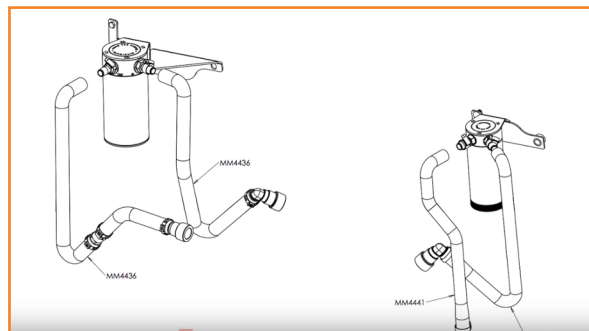

3. Remove the bolts on the ground strap and ECU cover. (1x 8mm bolt, 1x 10mm bolt)



4. Secure the bracket overtop the ground and ECU cover. Align the holes on the bracket with the empty bolt holes on the ground and ECU cover. An extra bolt and nut are in your kit to hold the top of the bracket. (1x 8mm bolt, 2x 10mm bolt, 1x 10mm nut)



5. Disconnect both ends of the stock PCV hose and remove it.

CONTINUED ON FOLLOWING PAGE

01

# 2011-2014 FORD F-150 3.5L ECOBOOST BAFFLED OIL CATCH CAN KIT INSTALLATION GUIDE



6. Connect your hose with the check valve to the intake manifold. The quick-disconnect end will be the side that attaches to this port.

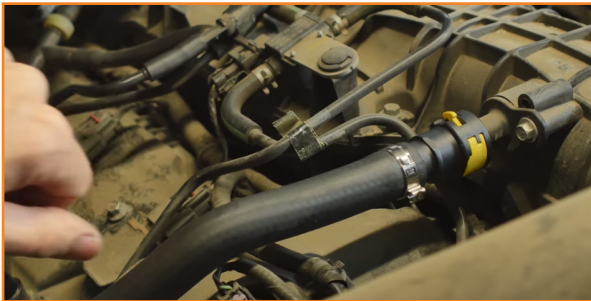

7. Connect the hose without a check valve to the valve cover. Again, the quick-disconnect end is what attaches to this port.



8. Attach the fittings to the 12 oz catch can.
9. Install the 12 oz catch can to the bracket using the included hardware. (4x 3jmm Allen bolts)
10. Connect the hose with the check valve to the catch can's OUT port. Secure the connection with one of the provided clamps. (1x worm gear clamp)



11. Connect the hose from the valve cover to the catch can's IN port. Secure the connection with one of the provided clamps. (1x worm gear clamp)



12. Attach the fittings to your 7.5 oz catch can.
13. Remove the original bolt and clip from the driver's side firewall. (1x pop-clip, 1x 10mm bolt)



14. Install the catch can and bracket to the driver's side firewall using the supplied hardware. (1x pop-clip, 1x 10mm bolt)
15. Install the 7.5 oz catch can to your smaller bracket. (3x 2.5mm Allen bolts)

CONTINUED ON FOLLOWING PAGE

# 02

## 2011-2014 FORD F-150 3.5L ECOBOOST BAFFLED OIL CATCH CAN KIT INSTALLATION GUIDE



16. Disconnect both ends on the CCV hose and remove it.
17. Install the first hose to the intake. The quick-disconnect end will attach to the port.
18. Attach the other end of the hose to the catch can's OUT port. (1x worm gear clamp)
19. Install the second hose to the valve cover. The quick-disconnect end attaches to this port.



20. Attach the open end to the catch can's IN port. (1x worm gear clamp)



21. Reinstall the engine cover and oil cap. To properly reinstall the cover, slide the back end in first with the front end still raised. Then lower the front.

**Congratulations! You have finished installing the Mishimoto 2011-2014 Ford F-150 3.5L EcoBoost Baffled Oil Catch Can Kit.**